

60W / 96W

Compact. Reliable. Powerful.

The MINI Series offers constant voltage power solutions in a compact format without compromising performance. Designed for residential and commercial lighting applications, these drivers deliver seamless phase (Triac / ELV / MLV) dimming and robust protection features. Compact size and integrated junction box makes them perfect for millwork applications. Backed by a 5-year warranty, the MINI Series is the perfect fit for projects that demand performance, value, and a seamless dimming experience.

FEATURES:

- Constant voltage output
- 120VAC
- Rated power 60W / 96W
- Full protection housing for dry, damp and wet locations
- Phase dimming: forward phase, MLV, reverse phase, ELV, TRIAC
- Dimming range: 0 - 100%
- THD < 20% @ 120V Max. load
- Small size: 127 x 82 x 41.8 mm / 5 x 3.22 x 1.64 inch (L x W x H)
- Super low loading request, works perfect at 20 - 100% load
- Short-circuit, over-load protection
- Great for residential and commercial lighting applications
- Surface installation
- 5 years warranty

MINI-XXW-120V-24V-PH-DRBX-BK

Rated Power		60W	96W
LM Number		LM42900-15	LM42900-16
Output	DC Voltage	24V	24V
	Voltage tolerance	±1.5V	±1.5V
	Rated current	2.5A	4.0A
	Rated power	60W	96W
Input	Voltage range	120VAC	120VAC
	Frequency range	47 - 63Hz	47 - 63Hz
	Power factor (typ.) @ full load	PF ≥ 0.94 @ 120VAC	PF ≥ 0.94 @ 120VAC
	THD (typ.) @ full load	<20%	<20%
	Efficiency (typ.) @ full load	88% @ 120VAC	88% @ 120VAC
	AC current (typ.)	0.93A	0.93A
	Leakage current	<0.5mA / 120VAC	<0.5mA / 120VAC
Protection	Short circuit	Hiccup mode, recovers automatically after fault condition is removed	Hiccup mode, recovers automatically after fault condition is removed
	Over load	Hiccup mode, recovers automatically after fault condition is removed	Hiccup mode, recovers automatically after fault condition is removed
Environment	Working temperature	-40°C ~ +60°C	-40°C ~ +60°C
	Working humidity	20-95% RH non-condensing	20-95% RH non-condensing
	Storage temperature, humidity	-40°C ~ +90°C, 10-95% RH non-condensing	-40°C ~ +90°C, 10-95% RH non-condensing
	Temperature coefficient	±0.03% / °C (0°C - 50°C)	±0.03% / °C (0°C - 50°C)
	Vibration	10-500Hz, 5G 10min. / 1 cycle, period for 60min. each along X,Y,Z axes	10-500Hz, 5G 10min. / 1 cycle, period for 60min. each along X,Y,Z axes
Safety & EMC	Safety standards	UL8750, Class 2	UL8750, Class 2
	Withstand voltage	I/P-O/P:1.88KVAC	I/P-O/P:1.88KVAC
Weight & Dimensions	Net Weight	0.17kg	0.17kg
	Dimensions	127 x 82 x 41.8mm (L x W x H)	127 x 82 x 41.8mm (L x W x H)

DERATING CURVE (OUTPUT LOAD VS. TEMP.)

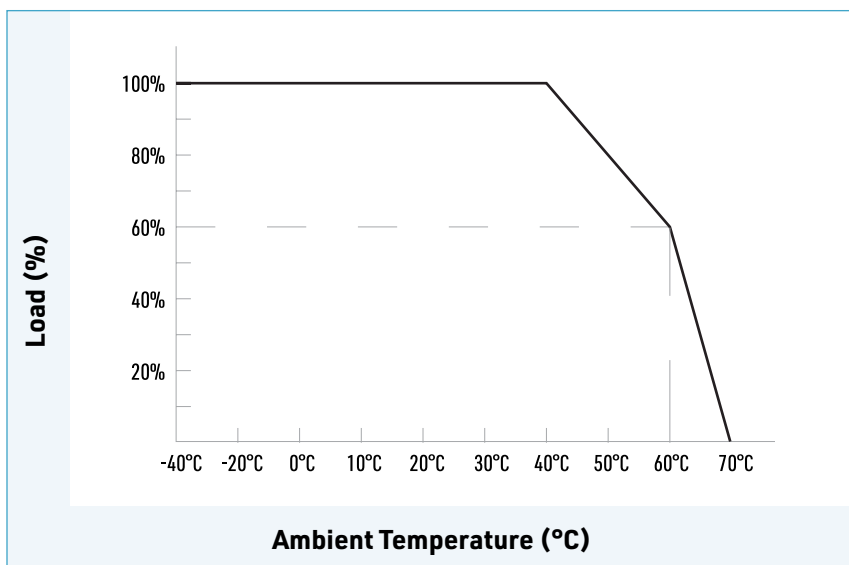

DIMENSIONS

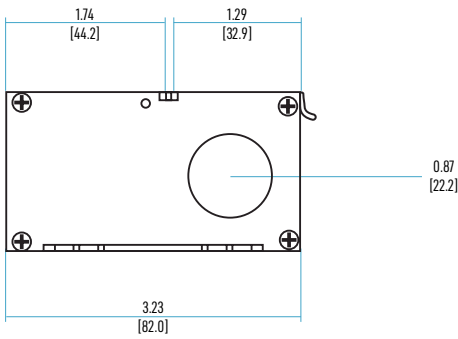
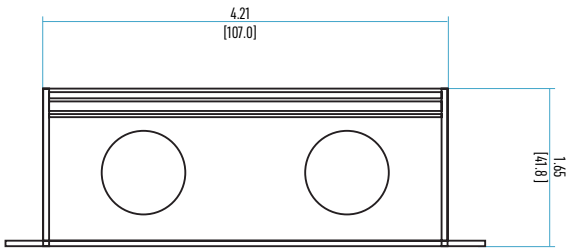
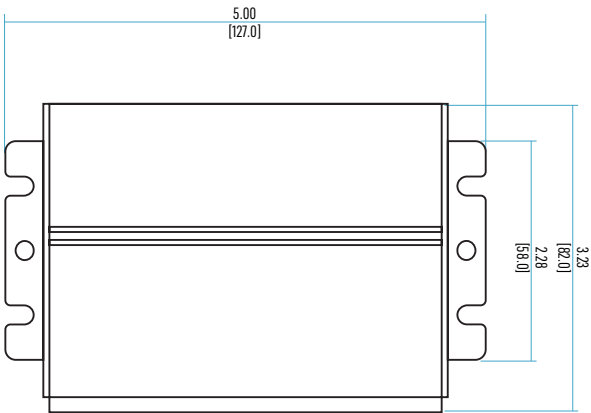

WIRING AND DIMMING DIAGRAMS

ELV DIMMING

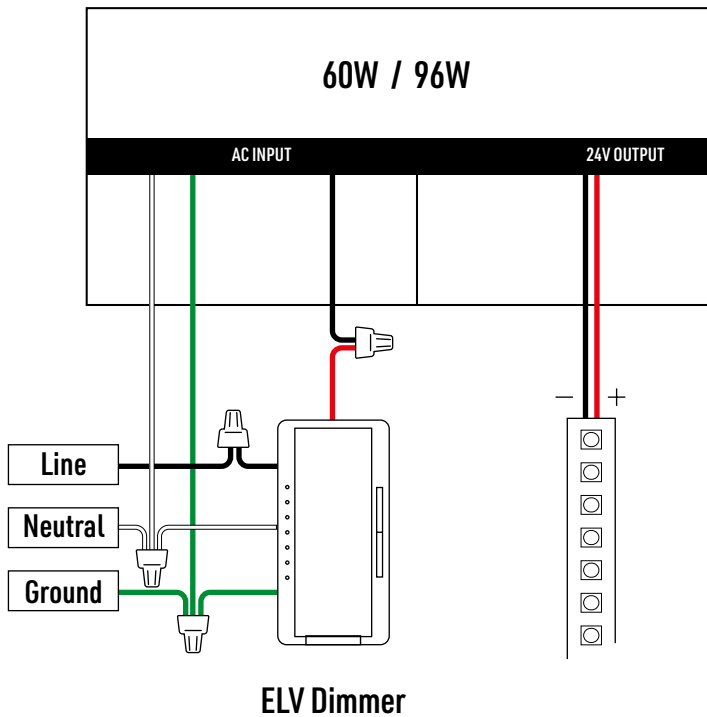

TRIAC / MLV DIMMING

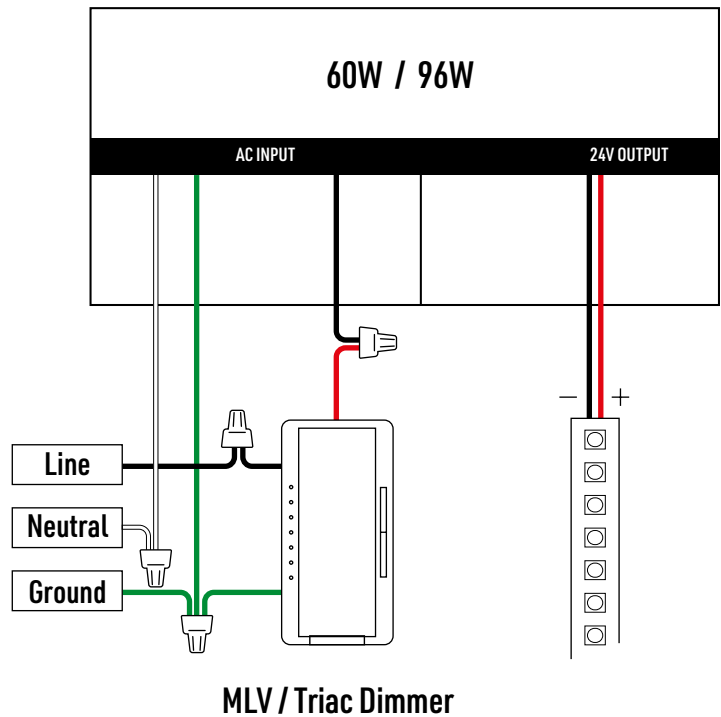

CLASS P DRIVERS

A **Class P driver** is a type of LED driver that follows **UL (Underwriters Laboratories)** standards for safety and performance. The main benefit is **interchangeability** – you can replace a Class P driver with another Class P driver (from any brand) **with same specifications** without needing to retest the entire lighting system for compliance.

Key Points:

- **Interchangeability** – Makes it easier to replace drivers without re-certification.
- **UL Safety Standard** – Ensures the driver meets thermal and electrical safety requirements.
- **Flexibility** – Manufacturers can switch to different Class P drivers based on availability or performance needs.